

**VILLAGE OF RICHLAND  
KALAMAZOO COUNTY, MICHIGAN**

**RESOLUTION RE: SANITARY SEWER CHARGES**

WHEREAS, the Village of Richland has previously adopted the Sewage Disposal System Ordinance, being Ordinance No. 008-2 (hereinafter "Ordinance") pertaining to the public sewer mains and public sewer service within the Village under the jurisdiction of the Gull Lake Sewer and Water Authority (hereinafter "Authority") acting as agent for the Village; and

WHEREAS, pursuant to Section 6 and other relevant sections of the Ordinance, it is the responsibility of the Village Council to determine certain appropriate fees/charges/rates relating to connection to and use of the public sanitary sewer system (hereinafter "Sanitary Sewer System"); and

WHEREAS, it is the desire of the Village Council to treat all customers similarly benefited and similarly situated equally to ensure the equitable allocation of the cost of the Management, Construction, Operation, Maintenance and Replacement of the Sanitary Sewer System as a whole, and to ensure that costs are levied in relevant proportion to the services being provided or able to be provided; and

WHEREAS, the Authority has recommended the following rates and charges be established.

NOW, THEREFORE, BE IT RESOLVED AS FOLLOWS:

A. All persons wishing to make a Service Connection to the Township's Sanitary Sewer System shall make application upon forms provided by the Authority and pay the charges provided for in this Resolution. For all Service Connections other than for single family residence service, the application may be required by the Authority to include a plot plan showing all underground utility structures, existing and proposed.

B. That the following Charges, payable to the Gull Lake Sewer and Water Authority, are hereby effective October 1, 2012 or as otherwise specifically noticed hereunder:

1. Direct Connection Fees: See portion of attached RATE SCHEDULE A pertaining to the Village of Richland.

Application of charges under Schedule A:

- a. Front footage shall be measured along highway, right-of-way, easement or other measurement as determined by the Authority.
- b. Those parcels located in a Special Assessment District and subject to a full special assessment shall be credited for a Direct Connection Fee for each Residential Equivalent Unit assessed.
- c. No refunds shall be due any customer as a result of the calculations hereunder.
- d. These costs do not include the property owner's cost to make the on-site connection from the home, business or structure to the available public sewer in the street or right-of-way.
- e. The Authority may elect to allow a customer to enter into an Installment Contract for Direct Connection Fees per the Ordinance subject to such terms as shall be established by resolution of the Authority Board. The Authority Board may, based upon cost of funds and financing arrangements/commitments, determine that certain districts may not utilize the Installment Plan for any given period of time.

2.	Indirect Connection Fee:	\$1,625.00 per REU
3.	Sewer Use Fee:	<p>\$70.00 per quarter per REU for all Sewer use, effective October 1, 2012</p> <p>\$74.00 per quarter per REU for all Sewer use, effective October 1, 2013</p> <p>\$78.00 per quarter per REU for all Sewer use, effective October 1, 2014.</p>
4.	Debt Retirement Fee	None at this time.
5.	Permit Fee/Inspection and Administrative Fee	As determined from time-to-time by the Authority Board (does not include the State permit fee where applicable)
6.	Bond for Local Contractors:	As determined from time-to-time by the Authority Board as may be necessary to protect the public infrastructure.

7.	Turn-on, Turn-off of Service	As determined from time-to-time by the Authority Board
8.	Re-Establishment of Service	As determined from time-to-time by the Authority Board
9.	Industrial Surcharges	As per the City of Kalamazoo ordinances
10.	Special Rates	None at this time
11.	Special Arrangements for Treatment costs at City of Kalamazoo	None at this time
12.	Surveillance fee	As determined from time-to-time by the Authority Board

C. The Authority, as agent for the Village, has established an Operation and Maintenance Fund, Contract Payment Fund, Replacement Fund and Capital Improvement Fund (or funds with similar purpose with similar names) into which the various charges provided by this Resolution may be deposited and from which disbursements may be made for Management, Construction, Maintenance, Repair, Replacement and Operation of the System.

D. Use Charges shall be billed to each customer connected to the System by the Authority based upon the number of residential equivalent units as set forth within the Ordinance and as administered by the Authority.

All resolutions or parts of resolutions in conflict with the provisions hereof are hereby rescinded.

Attch: Schedule.

Motion was made by Robert Prentice seconded by Virginia Gross to adopt the foregoing Resolution.

Upon roll call vote, the following members voted "Aye":

Doug Jonas, Robert Prentice, Virginia Gross  
Diane Briggs Jeff Heppler

The following members voted "Nay":

Paul Gobble

The Clerk declared the motion carried and the Resolution duly adopted.

**CERTIFICATE**

I hereby certify that the foregoing Resolution was accepted at a regular meeting of the Village of Richland held at Village of Richland Office on September 10, 2012; that the meeting was conducted and public notice of the meeting was given pursuant to and in full compliance with the Open Meetings Act of Michigan; that a quorum of the Board was present and voted in favor of the Resolution; and that the minutes of the meeting were kept and will be or have been made available as required by the Open Meetings Act.

VILLAGE OF RICHLAND

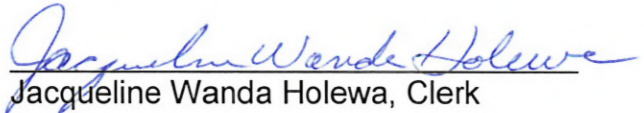

Jacqueline Wanda Holewa, Clerk  
8770 Gull Road  
Richland, MI 49083  
269-629-9903

SCHEDULE A: DIRECT CONNECTION FEES PER DISTRICT

<u>District Name</u>	<u>Location</u>	<u>Map reference</u>	<u>Cost per foot</u>	<u>Cost per 1<sup>st</sup> Unit</u>	<u>Cost per Unit Thereafter</u>
<u>Ross Township</u>					
Initial Gull Lake Sewer District	Gull Lake	Map 1 (*)	\$13	\$3250	\$3250
West M-89 #1 Sewer District	W. of 37 <sup>th</sup> St	<color map>	\$13	\$3250	\$3250
Initial 37 <sup>th</sup> Street Pressure District	37 <sup>th</sup> Street	<color map>	\$13	\$3250	\$3250
42 <sup>nd</sup> Street Interceptor	42 <sup>nd</sup> Street	<color map>	\$13	\$3250	\$3250
Gull Island Sewer District	Gull Lake	<color map>	\$0	\$15350	\$3250
Sherman Lake Pressure District (1)	Sherman Lake	<color map>	\$0	\$8696	\$3250
<u>Barry Township</u>					
Initial Gull Lake Sewer District	Gull Lake	<color map>	\$13	\$3250	\$3250
<u>Prairieville Township</u>					
Initial Gull Lake Sewer District	Gull Lake	<color map>	\$13	\$3250	\$3250
Little Long Lake Sewer District	L. Long Lake	<color map>	\$0	\$8600	\$3250
<u>Richland Township</u>					
Initial Gull Lake Sewer District	Gull Lake	<color map>	\$13	\$3250	\$3250
West M-89 #1 Sewer District	W. of 37 <sup>th</sup> St	<color map>	\$13	\$3250	\$3250
West M-89 #2 Sewer District	E/N of Village	<color map>	\$13	\$3250	\$3250
Foxwood/Englewood Sewer Dist	W of Village	<color map>	\$13	\$6000	\$3250
Gull Road Sewer District	Along Gull Rd	<color map>	\$13	\$6000	\$3250
<u>Village of Richland</u>					
West M-89 #2 Sewer District	Gull/DE/Yktown	<color map>	\$13	\$3250	\$3250
32 <sup>nd</sup> Street Sewer District	32 <sup>nd</sup> Street	<color map>	\$13	\$6000	\$3250
Bunkerhill Sewer District	Bunkerhill	<color map>	\$13	\$6000	\$3250

\*Maps on file at Gull Lake Sewer and Water Authority offices at 11829 E. M-89, Richland, MI 49083 and at [www.glswa.org](http://www.glswa.org).

(1) Per financing schedule, Connection Fee for Sherman Lake increases March 1<sup>st</sup> annually by the following schedule:

2008	\$8696
2009	\$8892
2010	\$9088
2011	\$9284
2012	\$9480
2013	\$9676
2014	\$9872
2015	\$10068
2016	\$10264
2017	\$10460
2018	\$10656
2019	\$10852
2020	\$11048
2021	\$11244

# GLS&WA DIRECT CONNECTION FEE DISTRICT MAP

-within-

## Richland Village/Township, Barry Township & Prairieville Township

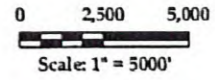

Prairieville Township,  
Barry County

Kalamazoo County, Michigan  
& Barry County, Michigan

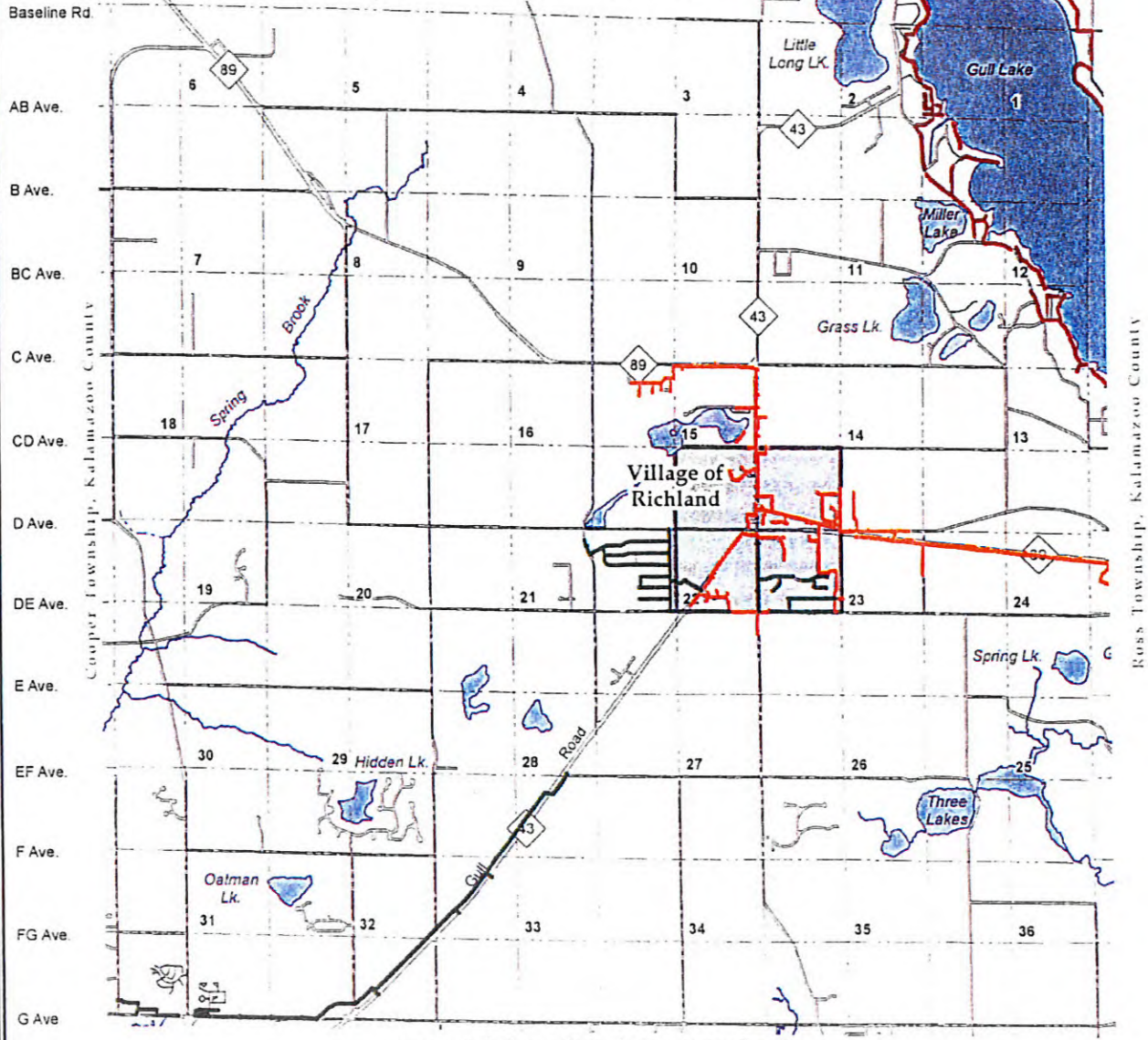

- \$0/Foot, 8,600/First Unit + \$3,250/Unit thereafter
- \$13/Foot, \$3,250/First Unit + \$3,250/Unit thereafter
- \$13/Foot, \$6,000/First Unit + \$3,250/Unit thereafter
- \$13/Foot, \$3,250/First Unit + \$3,250/Unit thereafter

Printed: May 2008  
**Prein & Newhof**  
Engineers & Surveyors & Civil Engineers & Architects

A:\GIS\GIS\2008\DirectConn\Map\Richland\RichlandMap.mxd