

NEW BUILDING FOR:
GULL LAKE SEWER AND WATER AUTHORITY
 7722 N. 37TH STREET
 RICHLAND, MICHIGAN 49083

LOWER LEVEL ELECTRICAL PLAN

HOWARD L. OVERBERG
 ARCHITECT, P.C.

198 EAST CENTRE
 PORTAGE, MICHIGAN

PHONE (269) 323-2422
 FAX (269) 323-2440

PROJECT NO.
 0000

DATE
 01/03/17

REVISION

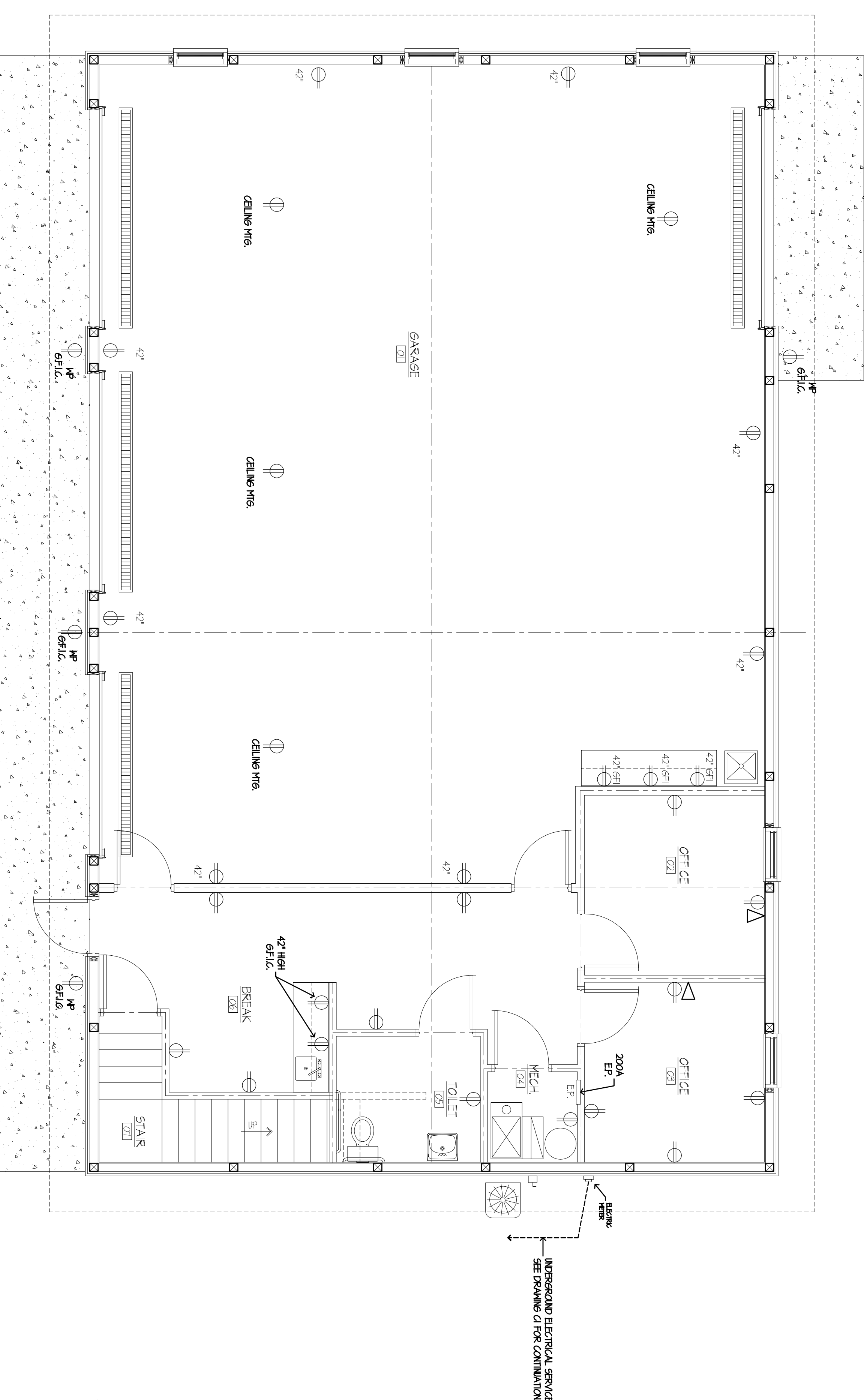

FIXTURE SCHEDULE

- A LINONUUA 20W LED ACRYLIC LAMP 120V SURFACE MOUNT
- B LINONUUA 104 LED ACRYLIC LAMP 120V SURFACE MOUNT
- C LINONUUA EMERGENCY EXIT COMBINATION LAMP LED-R40 CAT# EHX2LED
- D LINONUUA EMERGENCY EGRESS FIXTURE CAT# EHX2LED
- E LINONUUA REMOTE EMERGENCY HEAD IP CAT# E.A.HK-HX06
- F 15A INSTANTANEOUS 81A SINGLE ORANGE HIGH LED LAMP 120V CAT# B9000-15A-EHX2-LED-15990-081A CAT# (AS CALLED BY ARCHITECT)
- S 3-WAY SWITCH
- S SINGLE POLE SWITCH
- EF-1 EMAXIT FAN 50 CM

DIRECT RECEPTACLE ON DEDICATED CIRCUIT

LOCATION OF FLUSH SINGLE GANG TELEPHONE

LOCATION OF CEILING TELEPHONE CONDUITS WITH PLASTIC BINS AND ALL COVER PLATES AT ALL LOCATIONS (M9)

LOWER LEVEL ELECTRICAL PLAN

SCALE: 1/8" = 1'-0"

